

Wireless Laser Tachometer Model 7033



Features

- Laser Tachometer
- 20 to 3,600 RPM Range
- 0.1 RPM Resolution
- Easy Aligning Visible Laser Beam
- Solid State, No Moving Parts
- Length = 5.2" x 1.26" Diameter



Description

The 7033 wireless laser tachometer is used in conjunction with the 7034 wireless accelerometer. The laser tachometer projects a visible laser beam which can be directed to gear teeth, timing belts, or rotating shafts to measure running speed. The system requires a diffused reflective strip on the component to be measured, which allows the laser tachometer to detect the time between strip passings, converting this into CPM.

The laser tachometer is assigned to a workgroup of wireless accelerometers. The laser tachometer measures the running frequency whenever a wireless accelerometer within its work group transmits vibration data combining it with the vibration data at the network access point.

The 7033 is an extremely reliable wireless device. Handshaking, packet framing, collision avoidance, packet encoding, and error checking are all performed automatically. For maximum confidence, the 7033 performs periodic self-test diagnosis of power fluctuations, low battery, or harmful internal temperatures. Should operating parameters be exceeded, the unit will either alert the operator wirelessly or self-initiate a system reset.

Performance – All Models: $T_C=25^{\circ}\text{C}$ unless otherwise specified.

Parameter	Min.	Typ	Max	Units
Tachometer Measurement Range	20		3600	RPM
Frequency Resolution		0.5		RPM
Laser Frequency		670		nm
Laser to Reflective Tape Range	2		36	inches
Laser Output Power			5	mW
Laser Class (US)		IIIa		NA
Transceiver Operational Frequency		914.50		MHz
Radiated Power (ERP)			0	dBm
Wireless Range		250		feet
Weight		100		Grams
Operating Temperature	-10		50	$^{\circ}\text{C}$
Storage Temperature	-40		85	$^{\circ}\text{C}$
Operating Humidity, non-condensing	5		95	%

Ordering Information

Part Number: **7033000-1** Wireless Laser Tachometer (includes battery)
 Replacement Battery P/N 7033201-51
 Mounting Bracket P/N 7033090-1

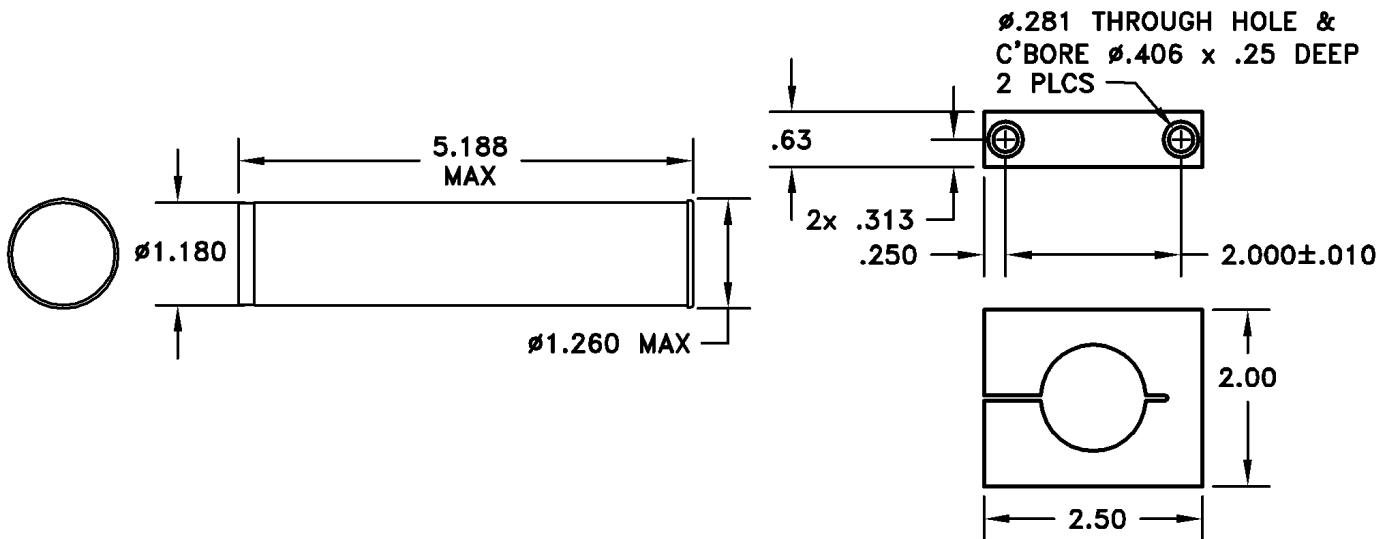

Rev A.1, Specifications subject to change without notice.